

The advertisement features a collection of various plastic plumbing components, including faucets, taps, and dispensing systems, arranged on a blue textured background. A prominent yellow hose is coiled in the upper center. The components are primarily white and cream-colored, with some red accents on the handles of the dispensing systems. The Hedwin logo is in the top right corner, and the company name and contact information are at the bottom.

HEDWIN

Quality.

Reliability.

Versatility.

**Taps, Faucets, Dispensing Systems
Products and Quality You Can Rely On.**

Hedwin Corporation 1600 Roland Heights Avenue Baltimore, MD 21211

800-638-1012 • 410-467-8209 • Fax 410-889-5189

HEDWIN

An Employee-Owned Company



(1) *Tube Dispenser Kit – 3/8" Gum Rubber Tubing (COM1050) 3/8" Latex Rubber (COM1058).* Kit has a flexible tube fitted to an adaptor & 38mm screw cap. Plastic medi-clamp valve provides shut-off and flow control. Comes individually packed.

(2) *Quick Serve Tap with 3/4" Threaded Adaptor (COM4444)* For applications with a 3/4" female threaded opening. Polypropylene molded tap, low density polyethylene molded threaded adaptor with rubber gasket.

(3) *Aeroflow Tap with 3/4" Adaptor (COM4408)* For applications with a 3/4" threaded adaptor. LDPE body molding, LDPE curved tube for venting, red polypropylene molded tap with insert for venting while dispensing, and HDPE molded threaded adaptor with a rubber gasket fitted into place.

(4) *2" Straight Through Drum Major Tap (COM4417)* For use with 2" NPSM drum opening. Injection molded of high density polyethylene, with on-off screw valve. Tap has a retaining ring and nitrile rubber washer. Exit port is in line with entry port. NPSM Gland (COM4491) and Cutter Adaptor (COM4439) also available.

(5) *Aeroflow Tap with 38mm Plastic Screw Ring (COM4406)* Aeroflow Tap with a 38mm plastic screw ring and gasket. Tap has "air return" feature that allows air back into container to dispense product without interruption.

(6) *3/4" Drum Tap (COM4411)* With 3/4" thread. Injection molded of HDPE. Valve is screw operated plug type. Unit has FDA approved rubber gasket in place. Can be screwed into a 3/4" NPSM female threaded opening. Nylon version available (COM4412).

(7) *38mm Quick Serve Tap (COM4401)* Low density polyethylene body molding, polypropylene molded tap and screw cap. Also: Quick Serve Tap and Mini-Bag (COM1428). Individual faucet bagged for cleanliness.

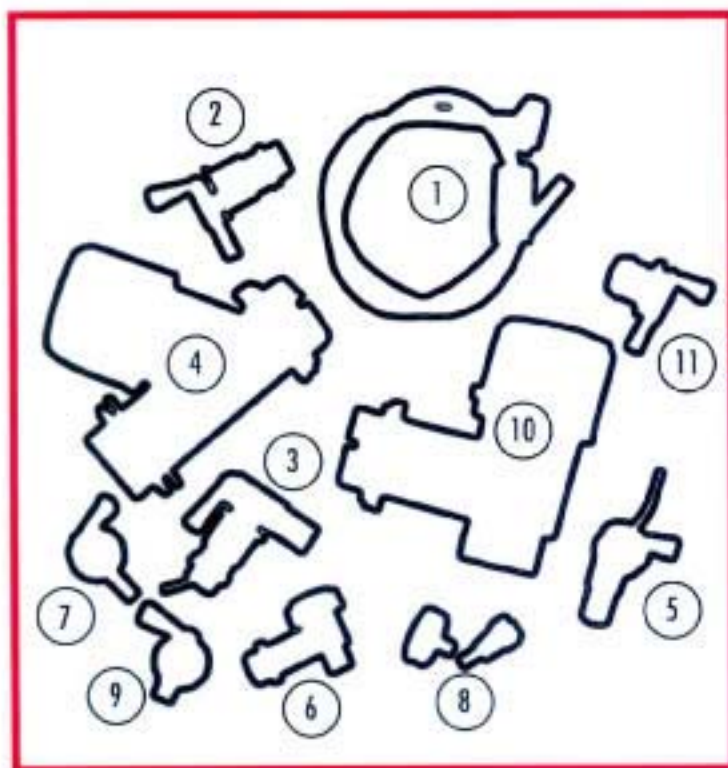

(8) *Colder Quick Connect Body – 1/4" I.D. (COM6837) 3/8" I.D. (COM6836)* Fast no spill connection with one hand coupling mechanism. Exit fitting for either 1/4" or 3/8" I.D. flexible tubing. Use with 38mm Puncture Seal Screw Cap (COM6835).

(9) *12mm Quick Serve Tap with 38mm Screw Ring (COM4448)* A variation of the standard Quick Serve Tap with low density polyethylene body, polypropylene molded tap with 12mm spout, screw ring, and gasket.

(10) *2" Drum Major Tap (COM4420)* For use with 2" NPSM drum opening. Injection molded of high density polyethylene, with on-off screw operated valve. NPSM Gland (COM4491) and Cutter Adaptor (COM4439) also available.

(11) *Quick Serve Tap, Plug Fit (COM4402)* Plug fit style faucet with low density polyethylene body molding and polypropylene molded tap.

Hedwin Corporation 1600 Roland Heights Avenue Baltimore, MD 21211

800-638-1012 • 410-467-8209 • Fax 410-889-5189